

Installing a Cavity Wall Vent in a Timber Frame Construction (As required by Timber Frame manufacturer)

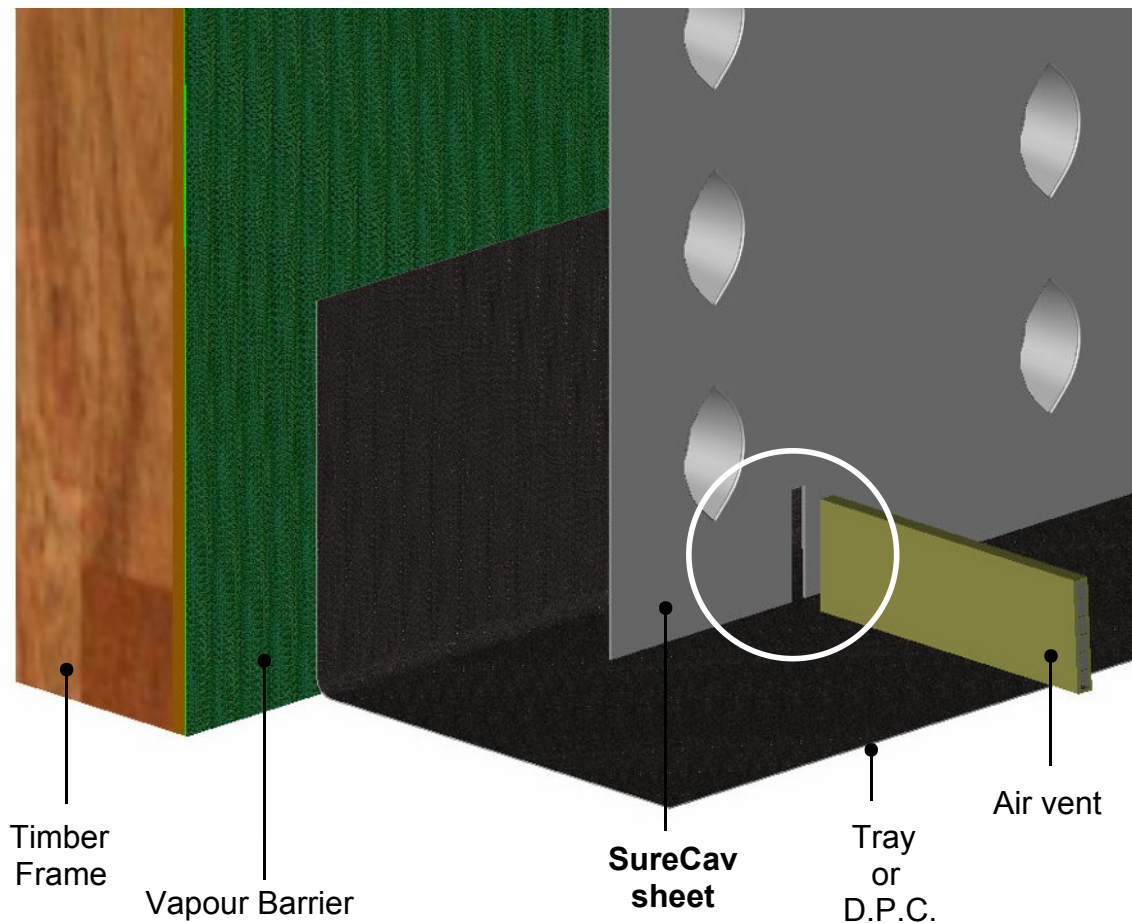

Cut a slot in the SureCav sheet 10mm wide and 65mm high to match the profile of the ventilator (as shown inside the white circle above). If the intended slot does not coincide with the edge of the SureCav sheet then simply drill a 10mm dia. hole at the top and bottom and cut the material away as shown on the right.

Compliance for Venting Timber Frame Buildings

The Building (Scotland) Regulations 2004

Vent wall cavities with a masonry outer leaf by installing ventilators with at least 300mm² free opening area at 1.2m maximum centres.

NHBC Standards

The cavity ventilation should conform to the requirements of the timber frame manufacturer.

SureCav recommends **Cavity Trays** for all your ventilation requirements.

The Type W may be used to provide the balanced air conditions demanded within the cavity in timber-frame construction. <http://www.cavitytrays.co.uk/ventilation/view/2/104/1/type-w>

For more information call us on 01963 34660
Or visit www.surecav.co.uk