

# SURECAV

New Technology for Cavity Wall Construction

## SureCav Cavity Spacer System

Will save you money, guarantee clean and moisture free cavities and create 5% extra internal floor space with narrower footings

SureCav, is a Cavity Wall Spacer System, BBA Approved 04/4154

SureCav has been developed to take the place of a backing block when building stone walls.

- It significantly reduces labour and material costs.
- It gives a faster cleaner build.
- It reduces the width of foundations by 100mm.
- It guarantees absolute integrity of the cavity. SureCav guarantees clean moisture free cavities that also stop water penetration from wind driven rain.
- It is environmentally friendly:
  1. Made from 100% recycled plastic
  2. Light weight easy to transport
  3. 80 times lighter than 100mm.concrete backing blocks
- It gives an extra 5% of floor space when original external dimensions are used
- It is durable and remains effective for the life of the building.
- Is now being used by forward thinking builders nation wide

Details of the cost savings, advantages and photographs are on our website: [www.surecav.com](http://www.surecav.com)



SURECAV ... an innovative new system,  
designed to reduce time and costs  
of cavity wall construction

## SureCav Technical Specification

The SureCav Cavity Wall Spacer System is a black, extruded and vacuum formed, high density polyethylene (HDPE) sheet, with raised spacer protrusions @ 260mm. centres. The sheets interlock via plastic joining H-section profile strips at all edges and corners when installed.

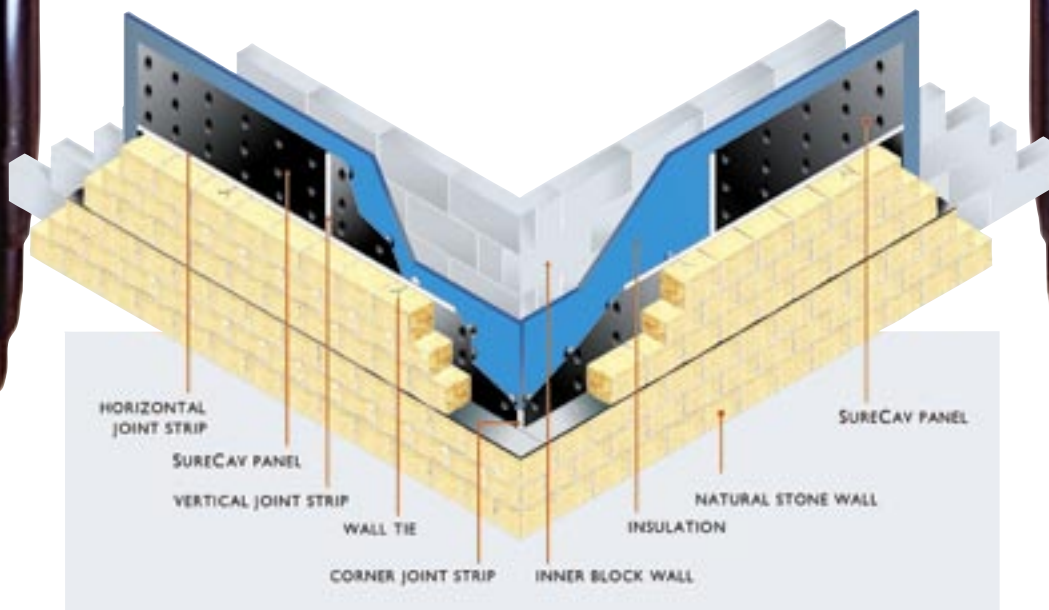

### System Characteristics

#### PANELS

Length (mm)	1200
Width (mm)	450
Total thickness(mm)	50
Sheet thickness(mm)	2
Spacer height(mm) 15 no.	48

#### JOINING STRIPS

Horizontal strip length(mm)	900
Vertical strip length(mm)	400
Vertical corner strip length(mm)	900

Ancillary items used with the panel include proprietary steel wall ties and clips (NOT SUPPLIED).

The SureCav Cavity Wall Spacer System is satisfactory to use in new, external cavity wall constructions. The system ensures a minimum cavity width of 50mm. when using natural or reconstituted stone outer leaf in conjunction with:

- Conventional masonry inner leaf, with or without partial fill cavity wall insulation (masonry includes clay, calcium silicate, concrete and stone units)
- Timber frame inner leaf.

The system may also be used with conventional clay and calcium silicate brick and concrete block outer leaves.

The system can be used in any exposure zone in buildings up to 12m. high.

The system must be used in conjunction with best building practice.



### New Technology for Cavity Wall Construction

SureCav Ltd • Holbrook Lodge • Holbrook • Wincanton • Somerset BA9 8BT  
24hr Tel: 01963 34660 • Mobile: 07971 484164 • Fax: 01963 32441/33700  
email: [info@surecav.co.uk](mailto:info@surecav.co.uk) • [www.surecav.co.uk](http://www.surecav.co.uk)

